

:: TOP & BOTTOM - BLANK PLATE

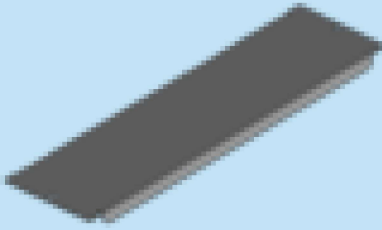

| ORDER NO RAL 9005 | TYPE | DESCRIPTION | DIMENSIONS (WxD)mm | THICKNESS | QTY |
|----------------------|----------|----------------------------|-----------------------|-----------|-----|
| 709 701 | 19A TBBP | Top & Bottom - Blank Plate | 440x130mm | 1.2mm | 01 |

:: TOP & BOTTOM - LOUVER PLATE

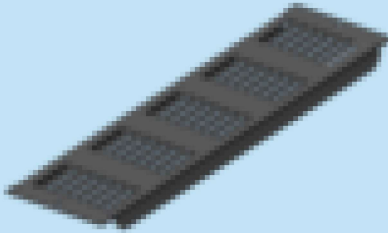

| ORDER NO RAL 9005 | TYPE | DESCRIPTION | DIMENSIONS (WxD)mm | THICKNESS | QTY |
|----------------------|----------|-----------------------------|-----------------------|-----------|-----|
| 709 706 | 19A TBLP | Top & Bottom - Louver Plate | 440x130mm | 1.2mm | 01 |

:: TOP & BOTTOM - LOUVER WITH AIR FILTER PLATE

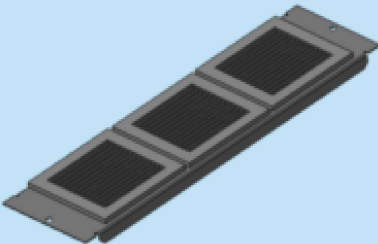

| ORDER NO RAL 9005 | TYPE | DESCRIPTION | DIMENSIONS (WxD)mm | THICKNESS | QTY |
|----------------------|-----------|---|-----------------------|-----------|-----|
| 709 781 | 19A TBLPA | Top & Bottom - Louver with Air Filter Plate | 440x130mm | 1.2mm | 01 |

:: TOP & BOTTOM - CABLE ENTRY PLATE WITH LOUVERS-MIDDLE ENTRY

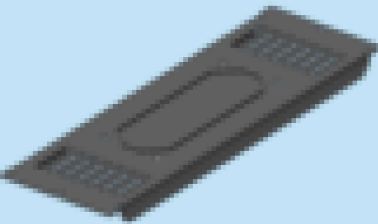

| ORDER NO RAL 9005 | TYPE | DESCRIPTION | DIMENSIONS (WxD)mm | THICKNESS | QTY |
|----------------------|-----------|--|-----------------------|-----------|-----|
| 709 711 | 19A TBSPM | Top & Bottom-Cable Entry Plate With Louvers-Middle Entry | 440x130mm | 1.2mm | 01 |

:: TOP & BOTTOM - SELF SEALING CABLE ENTRY PLATE-MIDDLE ENTRY

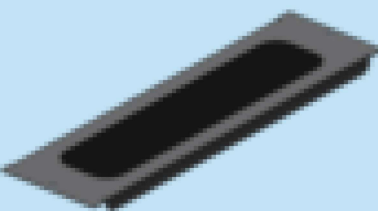

| ORDER NO RAL 9005 | TYPE | DESCRIPTION | DIMENSIONS (WxD)mm | THICKNESS | QTY |
|----------------------|------------|--|-----------------------|-----------|-----|
| 709 716 | 19A TBSCPM | Top & Bottom - Self Sealing Cable Entry Plate-Middle Entry | 440x130mm | 1.2mm | 01 |

Top & Bottom plates are inter-changable in all types of Wall Mounting 19" Racks & Free standing Racks.
RAL 7035 or any other color on request,subject to MOQ.

| | | | |
|-----------|------------|------------|------------|
| UPDATE ON | 21/03/2023 | REPLACE OF | 30/09/2022 |
|-----------|------------|------------|------------|

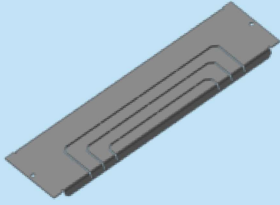

**:: TOP & BOTTOM - CABLE ENTRY
PLATE - SIDE ENTRY**

| ORDER NO RAL 9005 | TYPE | DESCRIPTION | DIMENSIONS (WxH)mm | THICKNESS | QTY |
|----------------------|-----------|---|-----------------------|-----------|-----|
| 709 727 | 19A TBCPS | Top & Bottom-Cable Entry Plate - Side Entry | 440x130mm | 1.2mm | 01 |

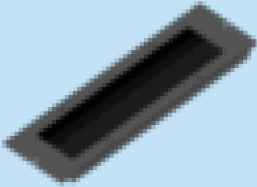

**:: TOP & BOTTOM - CABLE ENTRY
PLATE WITH BRUSH-MIDDLE
ENTRY**

| ORDER NO RAL 9005 | TYPE | DESCRIPTION | DIMENSIONS (WxH)mm | THICKNESS | QTY |
|----------------------|------------|--|-----------------------|-----------|-----|
| 709 787 | 19A TBCPBM | Top & Bottom-Cable Entry Plate with Brush-Middle Entry | 440x130mm | 1.2mm | 01 |

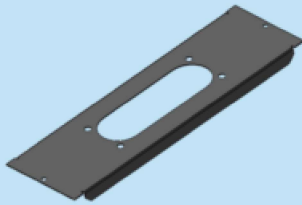

**:: TOP & BOTTOM - BLANK PLATE
FOR FL21 GLANDS**

| ORDER NO RAL 9005 | TYPE | DESCRIPTION | DIMENSIONS (WxD)mm | THICKNESS | QTY |
|----------------------|--------------|--|-----------------------|-----------|-----|
| 709 783 | 19A TBBPFL21 | Top & Bottom - Blank Plate For FL21 Glands | 440x130mm | 1.2mm | 01 |

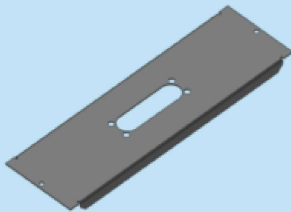

**:: TOP & BOTTOM - BLANK PLATE
FOR FL13 GLANDS**

| ORDER NO RAL 9005 | TYPE | DESCRIPTION | DIMENSIONS (WxD)mm | THICKNESS | QTY |
|----------------------|--------------|--|-----------------------|-----------|-----|
| 709 785 | 19A TBBPFL13 | Top & Bottom - Blank Plate For FL13 Glands | 440x130mm | 1.2mm | 01 |

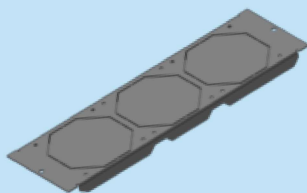

**:: TOP & BOTTOM - FAN PLATE - SEMI
PUNCHED - NO FANS**

| ORDER NO RAL 9005 | TYPE | DESCRIPTION | DIMENSIONS (WxH)mm | THICKNESS | QTY |
|----------------------|-----------|---|-----------------------|-----------|-----|
| 709 721 | 19A TBFPS | Top & Bottom - Fan Plate - Semi Punched - No Fans | 440x130mm | 1.2mm | 01 |

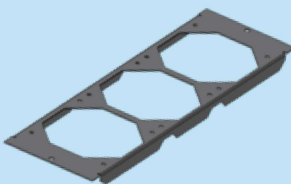

**:: TOP & BOTTOM - FAN PLATE - FULLY
PUNCHED - NO FANS**

| ORDER NO RAL 9005 | TYPE | DESCRIPTION | DIMENSIONS (WxH)mm | THICKNESS | QTY |
|----------------------|-----------|--|-----------------------|-----------|-----|
| 709 723 | 19A TBFPP | Top & Bottom - Fan Plate - Fully Punched - No Fans | 440x130mm | 1.2mm | 01 |

RAL 9005 or any other color on request,subject to MOQ.

| | | | |
|-----------|------------|------------|------------|
| UPDATE ON | 21/03/2023 | REPLACE OF | 30/09/2022 |
|-----------|------------|------------|------------|